

F

CERTIFIED RECORD OF LAND CORNER MONUMENTATION

**History of original corner establishment:**

The original corner was established in 1884 by Henry W. Cooke.

Set a basalt stone 16x8x8 ins, 10 ins in the ground for 1/4 sec cor. marked 1/4 on the N. face from which

A pine 36 ins diam bears S 34 E 70 lks dist marked 1/4SBT.

A pine 30 ins diam bears N 32 W 95 lks dist marked 1/4SBT.

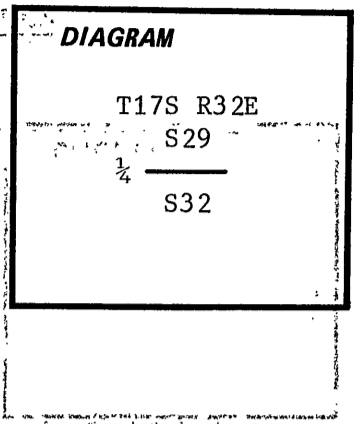

**Description of corner evidence found:**

Found a 19x6x5 stone, firmly set, marked 1/4 on the North face, in a mound of stone.

A 30" Ponderosa Pine bears N 31 1/2 W, 63.4 feet scribed 1/4S in an opened face.

**Description of monument and accessories | established to perpetuate the original location of this corner:**

Set a 3 1/4"x30" aluminum monument with magnet 22" in the ground in a mound of stone.

CAP MARKED

12" Ponderosa Pine bears S 77-3/4 W, 18.8 feet scribed 1/4S32BT.

T17S R32E  
S29

7" Ponderosa Pine bears N 11 W, 17.4 feet scribed 1/4S29BT.

1/4 ———  
S32

Bearing trees have a 3/4" brass washer marked LS 1918 attached between the B & T. Bearing tree measurements were made to the center of the tree. Painted faces and bands red and attached Attention signs and BT tags.

PLS 1918  
1985

Set a steel fence post West 3 feet with attention sign.

Work performed 13 May 1985

Witness: Louise H. Parsons

Tyler B. Parsons, PLS 1918  
1915 SE Stone Street  
Corvallis, OR 97333  
(503) 752-7515

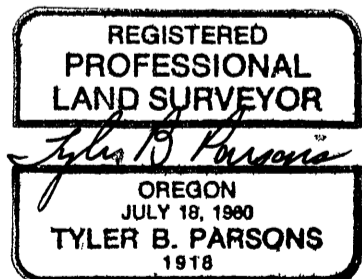

Road Cadastral Survey, Cont No 53-04H1-4-9665N

Office of Surveyor County of Grant  
State of Oregon I hereby certify that the within instrument was filed in this office  
for record on the 19 day of June, 1985  
Robert D. Smith by \_\_\_\_\_  
(COUNTY OFFICIAL) (DEPUTY)